



**2002-UP DODGE RAM QUAD CAB
PART #13133BB – STAINLESS STEEL BOSS RUNNING BOARDS**

Congratulations on your purchase of a high quality PUTCO product. Should you need any application or technical assistance feel free to call us at:
1-800-247-3974

Monday-Friday 8:00 a.m.- 5:00 p.m. (Central Standard Time)

Contact your PUTCO dealer for other quality accessories.

PUTCO Inc. - 216 West First Street - Story City, Iowa 50248

PLEASE READ ALL INSTRUCTIONS BEFORE BEGINNING INSTALLATION AND BE SURE TO CHECK TO SEE THAT ALL PARTS AND HARDWARE ARE INCLUDED.

Parts List

<u>Description</u>	<u>Qty</u>
Running boards	2
Flaps (#7422BB & #7423BB)	2
18" Mini-Trim (#7820)	2
Endcaps	2
Driver side bracket (#09340)	3
Passenger side bracket (#09341)	3
Rubber spacer (#8026)	6
1/4" x 1-1/4" SS Slot head screw (#726)	8
1/4" x 2" SS Slot head screw (#727)	6
1/4" x 3/4" Hex head bolts (#730)	12
1/4" Flange nut (#791)	20
1/4" Lock washer (#780)	20
5/16" Flat Washer (#771)	20
1/4" x 3/4" Self drill and tap screw (#701)	6
Metric U-nut (#00703)	6
8mm Bolt (#00704)	6
Foam tape (#678)	1 Roll

Tools Needed for Installation

- Power Drill
- 3/8 Magnetic drive socket
- Flat head screw driver
- 13mm Socket
- 7/16" Wrench and Socket
- Vise Grips
- Level

NOTE: Remove the protective plastic coating from the running boards and mud flaps. Trim the black vinyl tape on each end the running boards, so that the tape edge is flush with the end of the running board. The steps and figures shown are for the passenger side installation.

Step 1: Form the mud flaps to conform to the wheel well opening. **(SEE FIGURE 1)** Bolt the mud flap to the front of the board using 1/4" x 1-1/4" SS slot head screws and flange nuts. Next apply mini-trim **(#7820)** only along the outside edge of the mud flap **(optional)**. **(SEE FIGURE 1&4)**

Step 2: Attach an end cap to the rear of the board using 1/4" x 1-1/4" SS slot head screws and flange nuts. Now run a strip of foam tape along the top back side of the running board, and flush with the top edge of the board. **(SEE FIGURE 4)**

Step 3: Using the weld-ins on the board as a guide locate the existing holes in the rocker panel and remove the plastic caps. Place a u-nut **(#00703)** into the hole so that the u-nut goes towards the front of the truck. Mark the location of the hole in the u-nut and drill a 3/8" hole. Drill a 9/32" hole into the rocker panel directly below the 3/8" hole. Do this for each weld-in location.

Step 4: To attach the bracket to these holes you must first install the u-nut over 3/8" hole **(SEE FIGURE 3)**. Next run an 8mm Bolt through the bracket and u-nut. Attach the lower hole in the bracket to the 9/32" hole **(SEE FIGURE 3)** using a 1/4" x 2" Slot head bolt, lock washer, and flange nut on each bracket. **NOTE:** Use the rubber spacer with a flat washer on each side to fill the gap between the rocker panel and the bracket. Finger tighten. **(SEE FIGURE 3)**

Step 5: Attach the board to the brackets using 1/4" x 3/4" hex head bolts and flange nuts. Leave loose.

Step 6: Make sure the flap is flush against the wheel well and tighten the bracket bolts, check the board for alignment. Then tighten the bolts that attach the board to the brackets, and recheck the alignment of the board. **(SEE FIGURE 4)**

Step 7: Level the front of the running board, using three self drill and tap screws attach to mud flap to the fender well.

Step 8: Repeat the above steps for the driver side.

Note: PUTCO recommends applying a high quality automotive wax to maintain the original appearance on your new running boards.

Figure 1

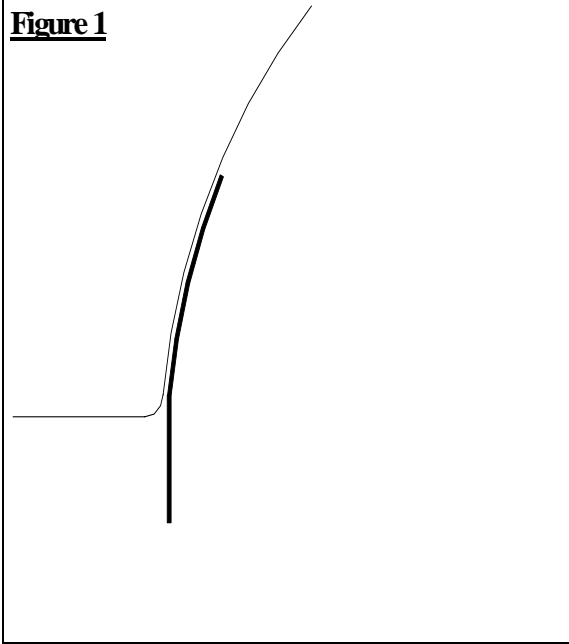

Figure 2

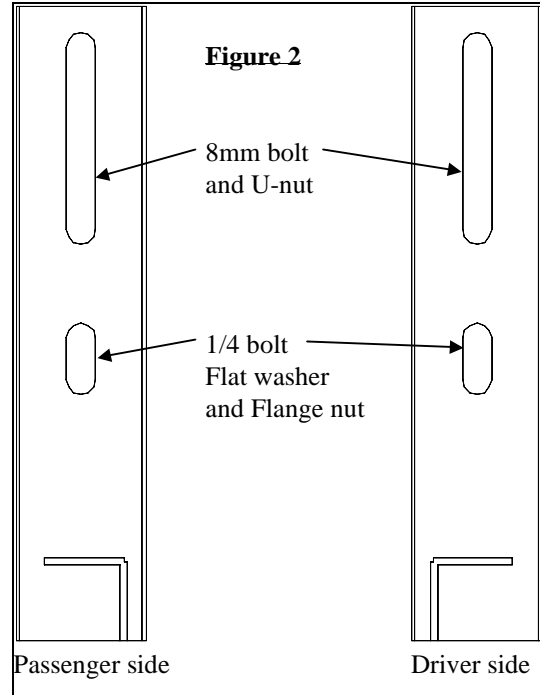

Figure 3

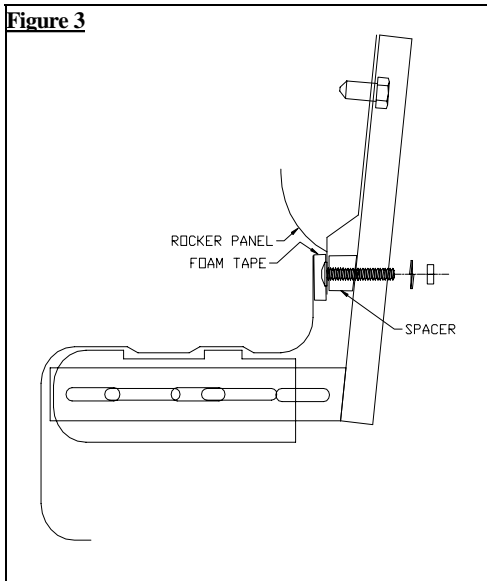
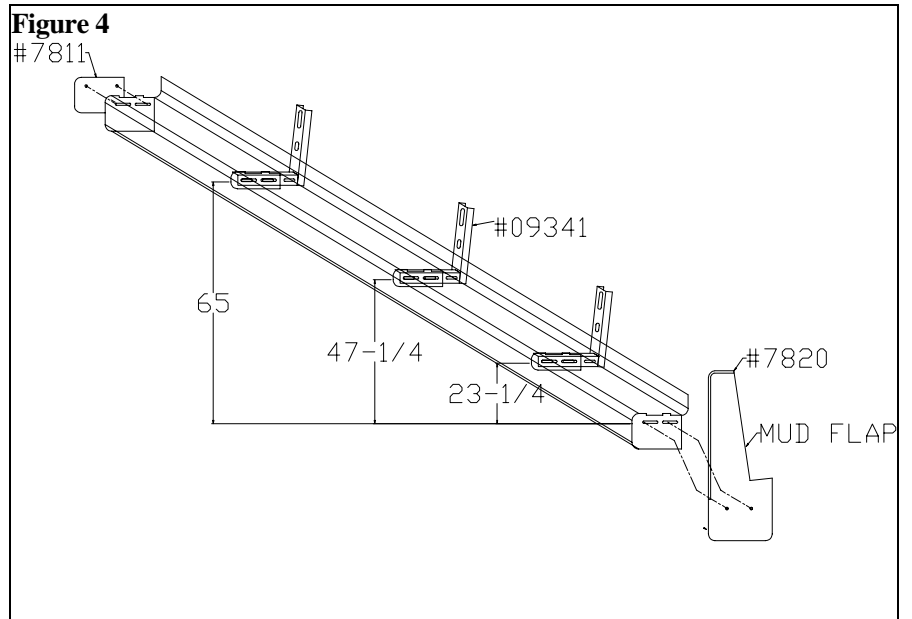

Figure 4



LIMITED WARRANTY

Putco guarantees its Stainless Steel and Aluminum products against defects in workmanship and material for as long as you own your vehicle. Black products have a 90 day warranty on the painted surface. Any defects resulting from faulty material or workmanship will be warranted by Putco and repaired or replaced at our discretion. Putco assumes no extra labor costs. Damages caused by freight carriers, improper installation, misuse, collision, or neglect will not be warranted by Putco.